

# Neillsville...

Yesterday, Today, Tomorrow

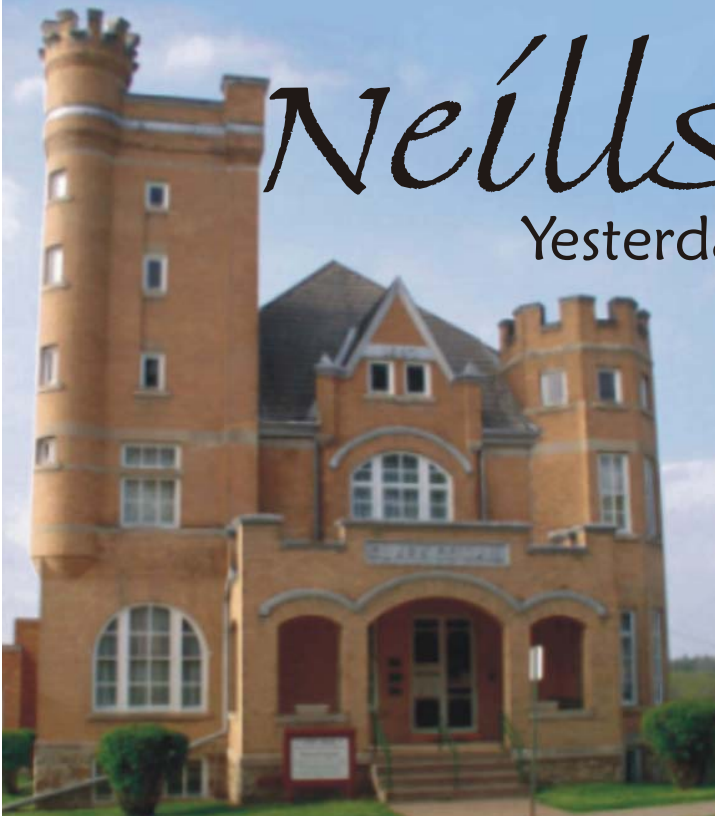



## *Welcome to Neillsville, Wisconsin*

Neillsville is a unique community nestled in the rolling hills of central Wisconsin surrounded by natural beauty, with strong historical and cultural roots.

Neillsville is a great place to visit or to call home. Whether you're an outdoor enthusiast, history buff, wildlife watcher, antique shopper, or sight-seer, you are sure to enjoy all Neillsville has to offer. Located in rural Wisconsin, Neillsville offers many amenities in a small town atmosphere with the metro areas of Minneapolis/St. Paul, Madison, and Milwaukee all within a convenient distance.

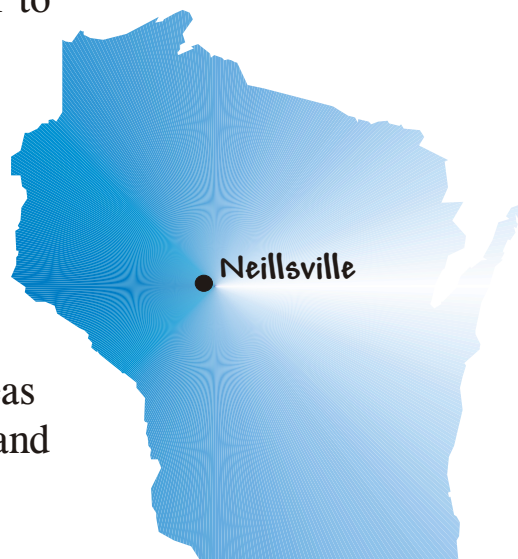

The friendly residents of Neillsville welcome you to visit for a day, a week, or a lifetime.

# Table of contents

Attractions . . . . .	2-5
Annual Celebrations . . . . .	9
Lodging and Eating Establishments . . . . .	6
City Information . . . . .	7,8
Municipal Airport . . . . .	8
Public Library . . . . .	8
Industrial Park . . . . .	9,10
Education . . . . .	10
Healthcare . . . . .	11
Housing . . . . .	12
City Map . . . . .	12
Special Happenings . . . . .	Inside Back Cover

## Brief History

Neillsville, the county seat of Clark County, was platted by A. Boardman for James O’Neill on April 14, 1855. At that time O’Neill’s residence and mill and Samuel Ferguson’s bachelor’s hall and blacksmith shop were the only buildings on the four acres appropriated. The surrounding countryside was sparsely populated with the first settlers drawn to the area for the logging industry. The greatest influx of new immigrants began shortly after Neillsville was platted and continued through the late 1800s. Most settlers came directly from European countries or from eastern parts of the United States, eager to homestead and farm in the new land.

The town was settled and became a commerce center for the surrounding countryside. The first industries included agriculture and lumber mills. A large furniture manufacturing plant was one of the first manufacturing industries as well as dairy production and canning operations.

Over the years Clark County has remained a strong agricultural area, although the number of farms decreases while the size of individual farms increases. Neillsville has kept pace with the modern economy adding new industry, services, housing, and commercial development to serve its residents. Today Neillsville continues to serve as the commerce, recreational, and educational center for the surrounding area.

## *Attractions*

Many would argue that the main attractions in the Neillsville area are the naturally occurring landscape and the many acres of forests, trails, and outdoor recreation areas which are open to the public. Neillsville is located in the Black River Valley among the rolling hills of Wisconsin. The ice age was responsible for the lakes, rivers, streams and moraines that are prolific in the area. The area is suited to outdoor activities year-round.

### *Natural Attractions*

Surrounding Neillsville are more than 130,000 acres of public forests managed by Clark County Department of Forestry and Parks and the Black River winds around the edge of the city. Recreational opportunities managed by the County include summer campgrounds, Bruce and Levis Mound winter sports areas, ATV trails, off-road motorcycle trails, snowmobile trails and public hunting grounds. A local ATV trail goes through the city of Neillsville.

For more information on the numerous recreational opportunities and amenities contact Clark County at [www.clark-cty-wi.org](http://www.clark-cty-wi.org), 715-743-5140 or 1-888-CLARK-WI

### *1897 Jail Museum*

The former Clark County Jail was placed on the National Register of Historic Places in 1978, the same year that the new jail was completed signaling the end of housing prisoners in the 1897 facility. The grand Romanesque building contained the sheriff's residence until 1974. The museum consists of the sheriff's residence which includes an old-fashioned parlor complete with a fireplace, a sitting room and other display room. Additional displays in the museum include the actual cell blocks for the men's section and also the women and juvenile section. Historical displays of flags, a replica telephone office, barber shop, and jewelry store are also included in the facility. Displays are updated and changed as new items are donated to the Jail Museum. For hours and cost please contact the Jail Museum directly at 715-743-4799 or the Neillsville Chamber office at 715-743-6444

### *Highground*

The Highground Veterans Memorial is located 3 ½ miles west of Neillsville on US Highway 10, at a spectacular overlook ridge encompassing more than 100 acres with views for miles. The memorial was developed and is maintained by the Wisconsin Vietnam Veterans Memorial Project, Inc., a private, non-profit organization. It is the mission of The Highground to honor veterans and their families. The plaza, which is triangular shaped and lighted in the evenings, covers approximately 45,000 square feet. On this plaza are placed Legacy Stones each of which is inscribed with the name of someone being honored with a lasting tribute.

The Highground includes tributes to veterans, POW/MIAs, and families who lost

loved ones in all of our nation's wars. Besides memorials, the site includes walking trails, picnic areas and shelters. Also located on the site is a Timber Frame Building which is built of 256 white oak interlocking timbers and held together with wooden pins. Housed inside is the information center and gift shop. Guided tours can be arranged. For more information call 715-743-4224 or visit the website at [www.thehighground.org](http://www.thehighground.org).

### *Wisconsin Pavilion*



The Wisconsin World's Fair Pavilion for 1964-65 can now be seen in Neillsville, Wisconsin. At the close of the Fair the pavilion was dismantled and returned to Wisconsin. It was purchased by a Boscobel man from the State of Wisconsin and was then put up for sale with the condition that it remain in Wisconsin. Central Wisconsin Broadcasting, Inc. purchased the Pavilion. The Rotunda became the home of WCCN FM and WCCN AM Radio and a gift shop. The Rotunda houses a display of items from the New York

World's Fair and other interesting artifacts.

### *Chatty Belle*

Chatty Belle, the world's largest talking cow, is located on the grounds of the Wisconsin Pavilion just off US Highway 10 in Neillsville. Along with Chatty Belle, visitors can see a replica of the 17 ¼ ton cheese, "The Golden Giant" housed in its glass-enclosed trailer.



### *Tuft's Mansion*

The Tuft's Mansion is a superb historical home that showcases the lavish lifestyle of Victorian times and the rich history of Neillsville. The home is now open as a "Bed and Breakfast with history and all that jazz," offering year-round lodging, historical tours, and jazz performances.

The original and current north portion of the house was built in 1879 and the larger south section of the home was added in 1885. Many of the home's unique details have been preserved and a wealth of historical information about Neillsville and the surrounding area is on display.



Tuft's Mansion offers a unique lodging experience through the exquisite Bed and Breakfast accommodations as well as a superb location for small to medium sized

parties and events. Live music performances, which are open to the public, also take place regularly. The museum is open for tours and group tours can be made by appointment. For hours, cost, and further information please contact the Tuft's Museum directly at 715-743-3346 or visit the website at [www.tuftsmansion.com](http://www.tuftsmansion.com).

## *Neillsville City Parks*

The City of Neillsville is home to nine unique city-owned park facilities:

Listeman Arboretum has 47 acres along the east bank of the Black River, with entrances on U.S. Highway 10 and W. Second Street by the Memorial Medical Center. Considered an outdoor classroom, the arboretum is criss-crossed with marked trails and benches for quiet contemplation and interpretive study, as well as providing an access for fishermen/women to the Black River. Park facilities include picnic tables and benches along the trails. No restroom facilities available.

C.C. Sniteman Town Square Park located at the intersection of Hewett Street (State Highway 73) and Fifth Street in the downtown business district, offers a place to sit and watch the people and traffic go by. Park facilities include benches and a gazebo for summer concerts and weddings. No restroom facilities available.



Cliff's Park, located at the intersection of W. Twelfth Street and Prospect Street, just three blocks west of Hewett Street (State Highway 73) on the city's northwest side, is a very nice, small neighborhood park. Park facilities include year-round restrooms, picnic tables, benches, and children's playground toys. Recreation facilities include lighted baseball field with bleachers and scoreboard, basketball court, sand volleyball court, and winter ice rink.

Fountain Park, located directly behind the American Legion Hall on Hewett Street (State Highway 73) along the south bank of O'Neill Creek, offers a place to sit and watch the rippling water pass you by. The O'Neill Creek Dam provides the back water for a small pond. Park facilities include picnic tables, benches and barbeque grills, no restrooms.

Listeman Park, located on E. Fifteenth Street, just two blocks east of Hewett Street (State Highway 73) on the city's northeast side, is a very nice large neighborhood park. Park facilities include seasonal restrooms, picnic shelter, picnic tables, benches, barbeque grills and children's playground toys. Recreation facilities include lighted baseball field with bleachers, scoreboard and press box, basketball court, sand volleyball court, and youth-only fishing pond.

Little Eddy, located just along the Black River bridge to the east of the intersection of Grand Avenue and Hill Road in the Town of Pine Valley along the north bank

of the Black River, provides a step back in time to the old fishing hole. A tree-lined canopy along a trail leads you to this out-of-the-way fishing spot, as well as access to various places along the river. No facilities.

Mount Moldy, located on Elm Street quietly tucked off the north end of Schuster Park, can be accessed from W. First Street or Willow Street, and provides a winter activity area. Park facilities include seasonal heated warming house with restrooms. Recreation facilities include tubing/sledding hill, winter ice skating/hockey rink with bleachers to cheer on your favorite pee-wee hockey team or figure skater.

Schuster Park, located on E. Division Street (U.S. Highway 10) on the city's southeast side is a very nice multi-use neighborhood park with a large picnic and playground area. Park facilities include two seasonal restrooms (north and south), two picnic shelters (north and south), picnic tables, benches, barbeque grills and children's playground toys. Of special interest is a part of the old Grand Avenue Bridge which was saved when the bridge was rebuilt. It is located on the northern edge of the park. Recreation facilities include lighted tennis courts, skateboard park, baseball backstop with grass field, basketball backboard, sand volleyball court, horseshoe pits and 15-hole disc golf course.



Tock Field, located on Park Street just south of the W. Fourth Street intersection on the city's southwest side, is a very nice small neighborhood park. Park facilities include seasonal restroom, picnic shelter, picnic table, barbeque grills, and children's playground toys. Recreation facilities include baseball field with bleachers and scoreboard, basketball court.

The picnic shelters at Listeman Park, Schuster Park and Tock Fields can be reserved for family events or other purposes by contacting the Parks Director at 715-743-7071

### *Neillsville country club*

Located adjacent to Schuster Park is Neillsville's beautiful nine hole golf course complete with recently remodeled club house which includes restaurant facilities. The country club has a colorful history which includes the club house being towed from the north side of town to its present location all the while with two men riding on top of the roof protecting the electric and phone lines. The golf course is open to the public seven days a week and with its gently rolling hills provides a scenic challenging course on which to play. This very well maintained course has been called one of the best nine hole courses in the state and is popular with the locals and visitors alike. Also popular is their Friday night fish fry which attracts a large crowd.

## *Lodging*

A variety of lodging facilities await you in Neillsville. For campground information contact Clark County Forestry and Parks at 715-743-5140 or 1-800-CLARK-WI, or visit [www.clark-county-wi.org](http://www.clark-county-wi.org).

## *Motels*

Fannie's Supper Club & Motel  
W3741 US Highway 10  
Neillsville, WI 54456  
715-743-2169

Heartland Motel  
7 S Hewett St.  
Neillsville, WI 54456  
715-743-4004

Moraine Motel  
W6949 Ridge Road  
Neillsville, WI 54456  
715-743-2517  
[www.morainemotel.com](http://www.morainemotel.com)

Super 8  
1000 East Division St.  
Neillsville, WI 54456  
715-743-8080  
1-800-800-8000  
[www.super8.com](http://www.super8.com)

## *Bed and Breakfast*

Tufts Mansion  
*The B & B With History & All That Jazz*  
26 Hewett Street  
Neillsville, WI 54456  
715-743-3346

## *Cabin Rentals*

Deegs Outdoor Adventure Cabin Rentals  
N2466 State Hwy 95  
Neillsville, WI 54456  
920-988-9416  
920-988-9414

## *Eating Establishments*

A wide variety of eating and drinking establishments are available in and around Neillsville from a quick bite to eat to an unhurried special meal. For the most up-to-date list of area restaurants visit the Neillsville Area Chamber of Commerce website at [www.neillsville.org](http://www.neillsville.org) or call 715-743-6444.

A & W Restaurant  
501 E. Division Street  
Neillsville, WI 54456; 715-743-7900

American Table II Family Restaurant  
111 E. Division St.  
Neillsville, WI 54456; 715-743-2696

Doc's Diner  
432 Hewett Street  
Neillsville, WI 54456; 715-743-2245

Donna's Cozy Kitchen  
630 Hewett Street  
Neillsville, WI 54456; 715-743-6335

Hardee's  
150 E. Division St  
Neillsville, WI 54456; 715-743-6585

M&M On The Main  
510 Hewett St.  
Neillsville, WI 54456; 715-743-6499

Pizza Hut, Inc.  
303 E. Division St.  
Neillsville, WI 54456; 715-743-3100

Subway Sandwiches  
7 S. Grand Avenue  
Neillsville, WI 54456; 715-743-3201

Neillsville Country Club  
603 E Division Street  
Hwy 10  
Neillsville, WI 54456, 743-3780



## *Retail Shopping*

Neillsville has an active downtown and highway commercial area that offer specialty shopping and general merchandise. Sporting goods, antiques, gifts, groceries, clothing, and discount retailers provide goods and services to the surrounding area. For a listing visit the Neillsville Area Chamber of Commerce website at [www.neillsville.org](http://www.neillsville.org) or call 715-743-6444.



## *City of Neillsville Information*

Mailing Address: 118 W. Fifth Street, Neillsville, WI 54456

- Telephone number: 715-743-2105
- Fax number: 715-743-2727
- E-mail: [neills@tds.net](mailto:neills@tds.net)
- Website: [www.neillsville-wi.com](http://www.neillsville-wi.com)

Neillsville city government consists of the Common Council, Mayor, other city officers and various committees, boards and commissions. The Common Council holds regular meetings on the second and fourth Tuesdays each month at 7:00 p.m. in the Council Room of City Hall.

City departments include the Municipal Airport, Cemetery, City Attorney, Clerk-Treasurer, Emergency Services (Police, Fire, Ambulance), Health Officer, Library, Recreation Department, Parks, and Public Works. For in-depth descriptions of the departments please visit the City of Neillsville official website at [www.neillsville-wi.com](http://www.neillsville-wi.com).

Neillsville emergency services include Police, Fire, and Ambulance protection all summoned by a central 9-1-1 emergency system. The Police force provides patrol 24 hours per day, 7 days per week. The fire department is a cooperative effort between the City of Neillsville and surrounding townships and consists of more than 25 volunteer firefighters. The ambulance service is staffed by 24 volunteer Emergency Medical Technicians (EMTs) and is also a cooperative effort with surrounding rural townships.

### Utility Service Providers:

Electricity:	Xcel Energy, 1-800-895-4999, <a href="http://www.xcelenergy.com">www.xcelenergy.com</a>
Natural Gas:	WE Energies, 1-800-714-7777, <a href="http://www.we-gas.com">www.we-gas.com</a>
Telephone:	TDS Telecom, 715-743-4601, <a href="http://www.tdstelecom.com">www.tdstelecom.com</a>
Cable TV:	Charter, 1-800-581-0081, <a href="http://www.charter.net">www.charter.net</a>
Water/Sewer:	Municipal, City of Neillsville, 715-743-2105
Refuse:	Onyx, 715-387-3101

## *Neillsville Municipal Airport*

Neillsville Municipal Airport (Airport Identifier: KVIQ)

Elevation: 1237, Unicom: 122.8, Green Bay Flight Service: 124.4

The Neillsville Municipal Airport is located three miles east of the city on U.S. Highway 10 at Miller Avenue. The airport, set among rolling farm fields, is one of the newest in Wisconsin, having been constructed in 1973 with the help of the Wisconsin Dept. of Transportation.

The blacktop surface of runway 09/27 measures 3,400 feet in length by 60 feet wide. This length offers ample room for most single engine aircraft, twins, turbo prop and some small jet aircraft. The runway is well marked with paint that can be seen during the day and with lights at night. Pilot controlled lighting as well as Non-Directional Beacon (NDB) instrument approach make this a very accessible airport year round.

The terminal building is open to the public and has restrooms, weatheration system and telephone access. Local taxi service and courtesy vehicles are available for transportation to and from the city's lodging and restaurant facilities. Airplane tie-downs are also available. If hangar space is desired contact the Fixed Base Operator.

The Fixed Base Operator offers a complete range of on-site services: aircraft refueling (100LL and Auto); flight instruction and pilot examinations; aircraft sales, leasing or rental; and aircraft maintenance. Call 715-743-4400 or 715-743-4700 for further information.

## *Neillsville Public Library*

The Neillsville Public Library had its beginning back in 1879 as the Neillsville Library Association, and was housed in various locations until 1914. Fortunately, the City of Neillsville had a direct link to the Carnegie Foundation via one Mrs. J.W. Hommel, who with her second husband was a resident of Neillsville. Mrs. Hommel's first husband was

George C. Carnegie, whose father was a nephew of Andrew Carnegie. Thanks in part to that relationship Neillsville was allotted \$10,000 for the construction of a new library. The Chicago architect, George Awsumb, was hired to design the building. True to Carnegie standards, the brick structure stands stately atop a hill and

remains today in its original splendor. Following their original lead the city constructed an addition in 1994 nearly doubling the size of the library facility while remaining true to the Carnegie brick design.



## Annual Celebrations

Heritage Days is celebrated the second weekend in July throughout Neillsville including the Miss Neillsville coronation, parade, many special events, food and beverage. This event is truly fun for the whole family.

The Clark County Fair is held in Neillsville annually the second Wednesday through Sunday in August. The fair features traditional county fair activities including animal showing and competition, carnival, and many special events. For the latest information about the fair visit the Clark County University of Wisconsin Extension office website at [www.uwex.edu/ces/cty/clark/](http://www.uwex.edu/ces/cty/clark/) or call 715-743-5121.

Another event which is held every year in February is the Winter Carnival. For more information on this contact the Neillsville Area Chamber of Commerce office at 715-743-6444

## Neillsville Industrial Park

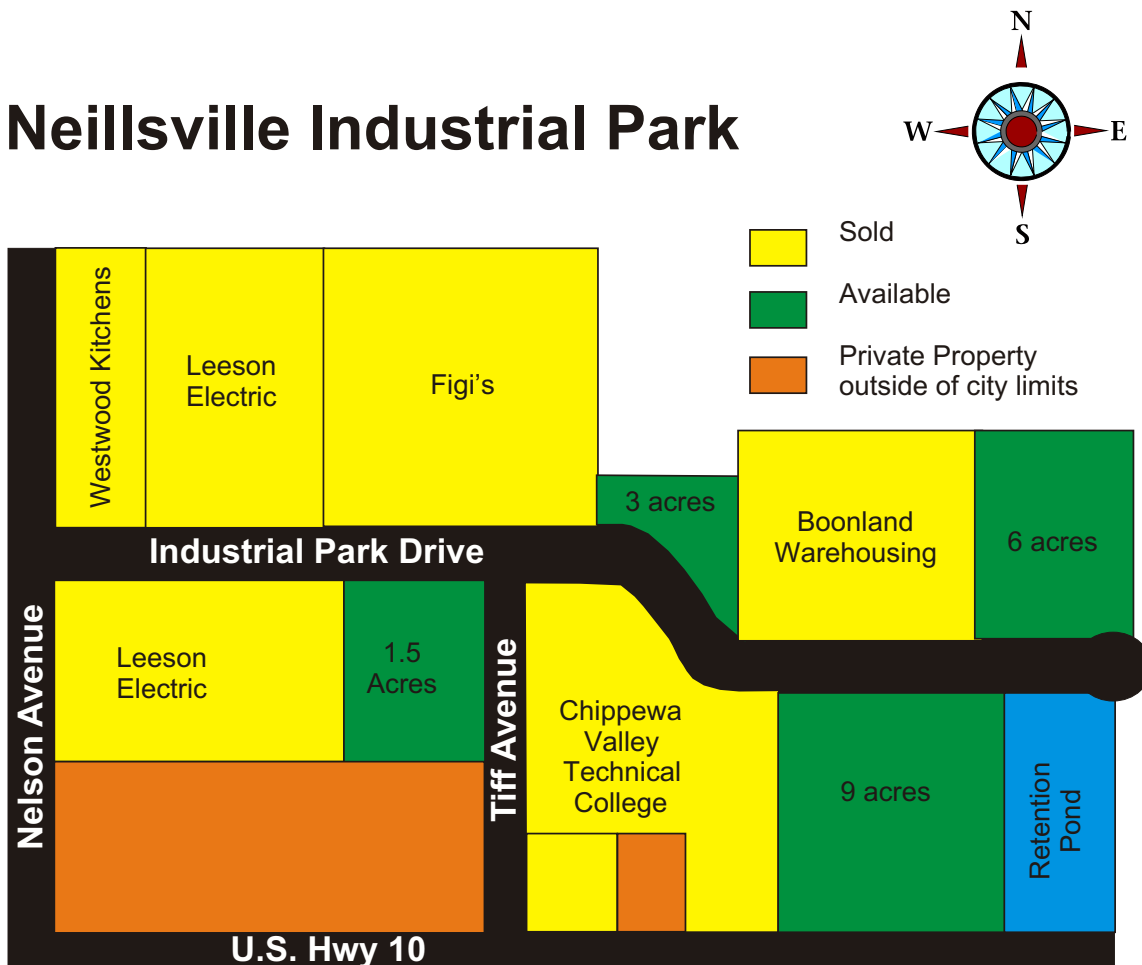

*Not to scale, artist rendition only*

## Neillsville Industrial Park

The Neillsville Industrial Park is a fully-served municipally owned industrial park located along U.S. Highway 10 in Neillsville. The park consists of 67 acres with 21 acres currently available. 30 acres of adjacent property are also available and planned for industrial development.



The City of Neillsville owns all available land in the industrial park. The price is negotiable and projects that retain or create jobs in Neillsville may qualify to receive the land they desire for little or no cost.

The City of Neillsville has a Business Loan Fund that can be used for commercial and industrial projects. The purpose of the fund is to encourage the creation of quality jobs and to increase the tax base.

Major employers include: Clark County, Fleetguard Nelson, Memorial Medical Center, Leeson Electric Motors, and the Neillsville School District.

## Education

Neillsville Public Schools  
(<http://www.neillsville.k12.wi.us/>)  
614 East 5th St.  
Neillsville, WI 54456  
Telephone: 715-743-3323  
Fax: 715-743-8814



The Neillsville Public School system provides top notch opportunities in a fun and safe environment for its students. Besides many class

offerings, the district has many extra-curricular activities available for students and families. Neillsville public schools work as a partner to local businesses and post-secondary educational facilities throughout the state.

Chippewa Valley Technical College ([www.cvtc.edu](http://www.cvtc.edu)) Phone 715-743-3965

Chippewa Valley Technical College has a new campus in Neillsville's Industrial Park. The new center will allow area residents and businesses to have immediate access to the latest training and technology locally. The college currently serves the area with regular classes at the Eau Claire campuses and special courses provided off-site in cooperation with the local school district and area employers.

University of Wisconsin System (<http://www.uwsa.edu/>)

The University of Wisconsin system serves central Wisconsin with a number of campuses. Nearest to Neillsville is the 2-year UW Marshfield/Wood County

center. The nearest 4-year campuses are UW-Eau Claire and UW-Stevens Point. The UW system offers many programs and courses to suit a wide range of interests.

#### Clark County Alternative School

1115 W 4th St.

Neillsville, WI 54456

715-743-7443

#### St. John's Evangelical Lutheran School

805 W. 5th St.

Neillsville, WI 54456

715-743-2501

#### Indianhead Community Action Agency-Headstart

700 E. 15th St.

Neillsville, WI 54456

715-743-4599

## *Healthcare*

#### Memorial Medical Center

[www.mmneillsville.com](http://www.mmneillsville.com)

216 Sunset Place

Neillsville, WI 54456

715-743-3101



Neillsville is home to Memorial Medical Center, a full-service medical facility offering a wide range of care for a population base of 12,000 individuals in the southern Clark County area with clinics located in Neillsville, Greenwood, Loyal and Fairchild. Services include: Cardiac Rehabilitation, Dietary, Diabetic Education, Emergency Care (ER), Hospital, Home Health, Laboratory, Nursing Home, Obstetrics, Occupational Therapy, Pain Management Clinic, Podiatry, Pharmacy, Physical Therapy, Radiology, Respiratory Therapy, Speech Therapy, Sports Medicine, Surgery, Social Services, and Urgent Care.

Additional healthcare providers including chiropractors, dental offices and more are located in Neillsville. For the most up-to-date listing visit the Neillsville Area Chamber of Commerce website at [www.neillsville.org](http://www.neillsville.org) or call 715-743-6444.

# Housing

A main point of interest in Neillsville is the significant number and excellent condition of historic homes in the community. Homeowners throughout the community take great



pride in their homes and you will find many streets in town that reflect the great community pride and appreciation for days gone by.

New housing developments within the City of Neillsville, rural developments, and a variety of rental housing opportunities provide all options for housing in

Neillsville. For a listing of local real estate professionals visit the Neillsville Area Chamber of Commerce website at [www.neillsville.org](http://www.neillsville.org) or call 715-743-6444.

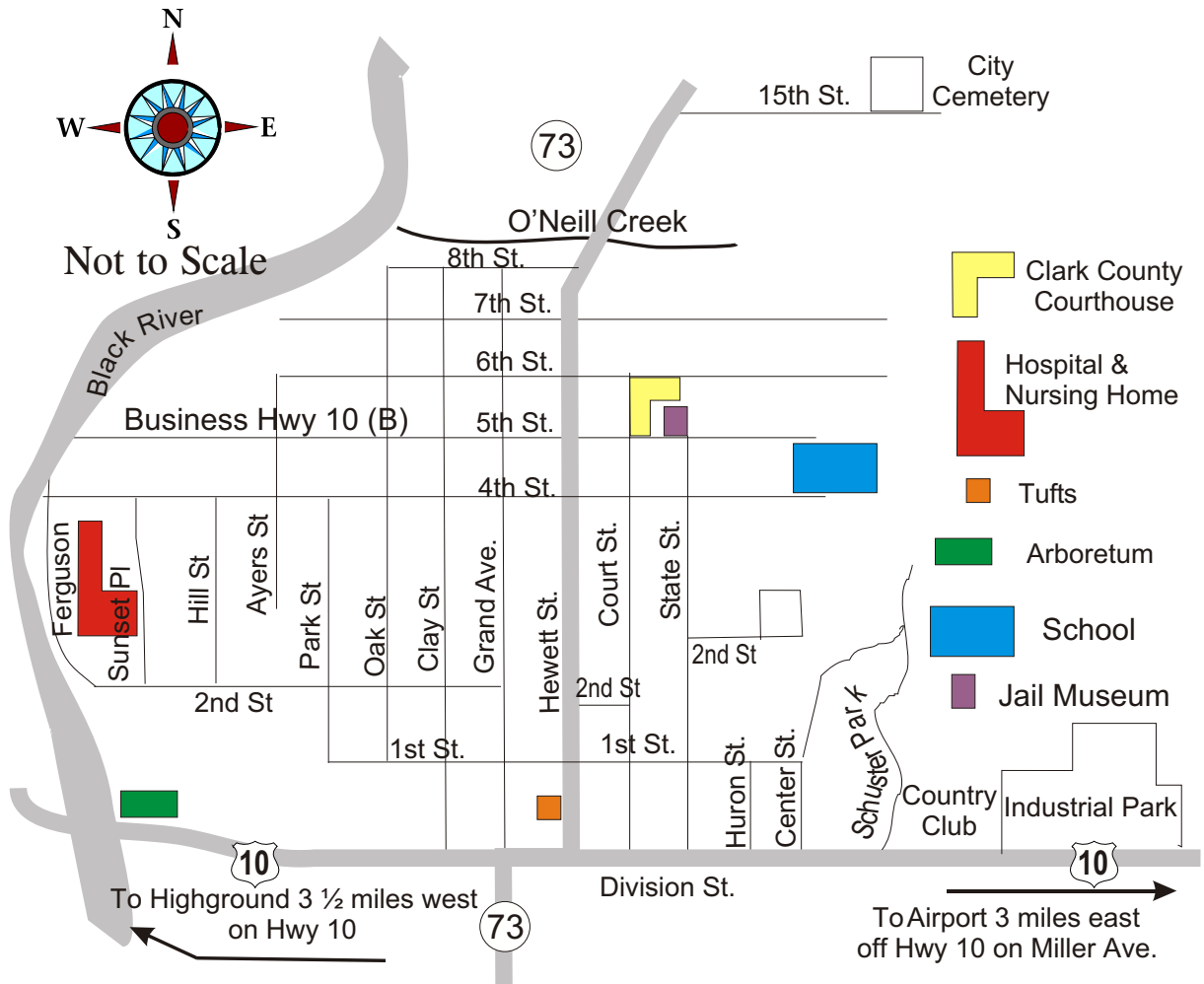

## *Special Happenings*

Wilderness Pursuit  
Larry & Lynette Engevold  
N5773 Resewood Ave  
Neillsville, WI 54456  
715-743-4484 or 877-896-4221  
[www.wildernesspursuit.com](http://www.wildernesspursuit.com)

Enjoy wonderful horses and ride them in beautiful surroundings. Custom planned primitive outing trips. Cabins available. Youth camps offer a five day stay. Everything except personal gear and bedroll is included. Explore beautiful rural Neillsville.

Neillsville Area Players, Inc.  
PO Box 21  
Neillsville, WI 54456  
715-743-2109  
715-743-4765

This group is open to area talent. They have presented various productions since the fall of 2001, some of which include Oklahoma, Hello Dolly and the Golden Goose. There are two major productions per year.

Snyder Park  
Clark County Forestry & Parks  
517 Court Street  
Neillsville, WI 54456  
[www.clark-cty-wi.org](http://www.clark-cty-wi.org)

Six miles west of Neillsville on Snyder Lake. Open May 2 - Dec 1. No advance reservations. Thirty-two camp sites, beach area, trail access, drinking water, picnic areas, shelters, play areas, boat launch, fishing access, toilets, & electric

Double R Horse Company  
Randy & Julie Reineck  
N3780 County Hwy K  
Granton, WI 54436  
715-238-8088  
[www.centralwihorsesale.com](http://www.centralwihorsesale.com)

Large horse sale that covers 13 states and Canada. There are two large sales held every year at the Clark County Fairground in Neillsville. The spring sale is the third week in April and the fall sale is the third week in September, held Wednesday through Saturday.

American Legion Post 74  
P.O. Box 204  
Neillsville, WI 54456  
715-743-3859

Has been located in downtown Neillsville for the past 60 years. A new Legion Hall will be constructed on Boon Blvd., to be completed by late 2005 or 2006. The new facility will easily accommodate weddings, business meetings and reunions of more than 400 people.



# The Highground

